

KENWOOD

KNA-DV3100

DVD NAVIGATION SYSTEM

INSTALLATION MANUAL

KENWOOD CORPORATION

Safety precautions

▲WARNING

To prevent injury or fire, take the following precautions:

- Insert the unit all the way in until it is fully locked in place. Otherwise it may fall out of place when jolted.
- When extending the ignition, battery, or ground wires, make sure to use automotive-grade wires or other wires with a 0.75mm² (AWG18) or more to prevent wire deterioration and damage to the wire coating.
- To prevent a short circuit, never put or leave any metallic objects (such as coins or metal tools) inside the unit.
- If the unit starts to emit smoke or strange smells, turn off the power immediately and consult your Kenwood dealer.

▲CAUTION

To prevent damage to the machine, take the following precautions:

- Make sure to ground the unit to a negative 12 V DC power supply.
- Do not open the top or bottom covers of the unit.
- Do not install the unit in a spot exposed to direct sunlight or excessive heat or humidity. Also avoid places with too much dust or the possibility of water splashing.
- Do not subject the faceplate to excessive shock, as it is a piece of precision equipment.
- When replacing a fuse, only use a new one with the prescribed rating. Using a fuse with the wrong rating may cause your unit to malfunction.
- To prevent short circuits when replacing a fuse, first disconnect the wiring harness.
- Do not use your own screws. Use only the screws provided. If you use the wrong screws, you could damage the unit.

Cleaning the Unit

If the faceplate of this unit is stained, wipe it with a dry soft cloth such as a silicon cloth. If the faceplate is stained badly, wipe the stain off with a cloth moistened with neutral cleaner, then wipe neutral detergent off.

▲CAUTION

Applying spray cleaner directly to the unit may affect its mechanical parts. Wiping the faceplate with a hard cloth or using a volatile liquid such as thinner or alcohol may scratch the surface or erase characters.

Lens Fogging

Right after you turn on the car heater in cold weather, dew or condensation may form on the lens in the DVD player of the unit. Called lens fogging, DVDs may be impossible to play. In such a situation, remove the disc and wait for the condensation to evaporate. If the unit still does not operate normally after a while, consult your Kenwood dealer.

Reset

When installation is complete, check the connections. If everything is in order, press the reset button. If the unit does not seem to be working right, try pressing the reset button first. If that does not solve the problem, consult your Kenwood dealer.

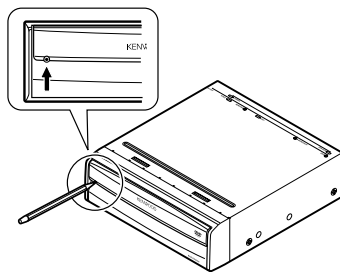

The Mark Position of Your Car Immediately After Installation

- Immediately after installation, the information of the GPS satellite is taken in and it may take several minutes to measure the position of the current location.
- Immediately after installation, the initial value setting of the gyro sensor is required. After measuring the position of the current location, drive of about 6.2 mile (10 km) and further at a constant speed at least 24.8 mile/h (40 km/h) in a place where there are few obstacles (for example, buildings and tree-lined streets).

NOTE

- Until the initial values are set, the position and speed indication of you car's mark on the navigation system may differ greatly from the actual values.
- The proper connection of the car speed signal wire can be checked with the menu screen. Please see the instruction manual for details.

Installation Procedure

- 1 To prevent short circuits, remove the key from the ignition and disconnect the \ominus battery.
- 2 Make the proper input and output wire connections for each unit.
- 3 Connect the wiring harness wires in the following order: ground, battery, ignition.
- 4 Connect the wiring harness connector to the unit.
- 5 Install the unit in your car.
- 6 Reconnect the \ominus terminal of the battery.
- 6 Press the reset button.(See page 3)

CAUTION

- If your car's ignition does not have an ACC position, connect the ignition wires to a power source that can be turned on and off with the ignition key. If you connect the ignition wire to a power source with a constant voltage supply, as with battery wires, the battery may die.
- If the fuse blows, first make sure the wires aren't touching to cause a short circuit, then replace the old fuse with one with the same rating.
- Do not let unconnected wires or terminals touch metal on the car or anything else conducting electricity. To prevent a short circuit, do not remove the caps on the ends of the unconnected wires or the terminals.
- After the unit is installed, check whether the brake lamps, blinkers, wipers, etc. on the car are working properly.
- Insulate unconnected wires with vinyl tape or other similar material.

Installation

■ Accessories

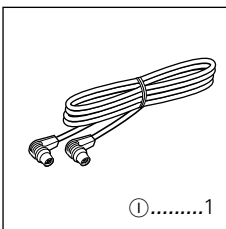
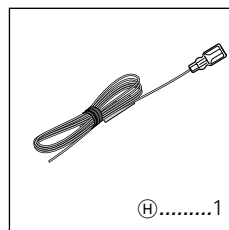
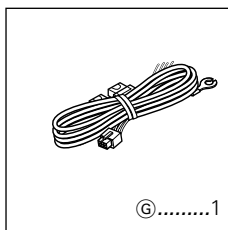
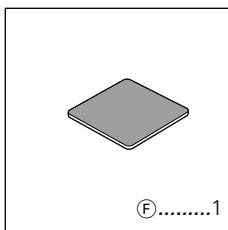
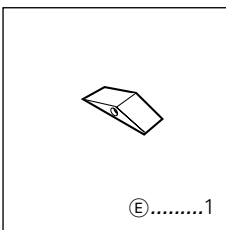
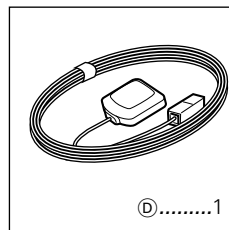
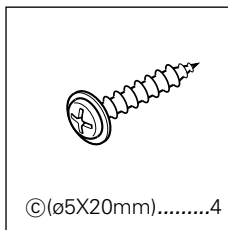
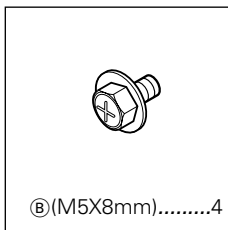
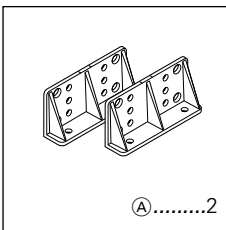

■ Installation for Navigation System

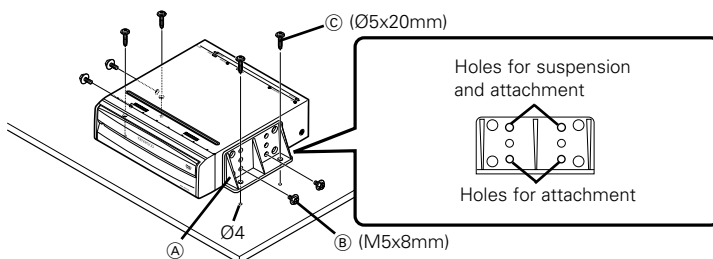

▲ CAUTION

- Select for installation a location where the unit can be placed completely horizontal.
- Be sure to firmly stabilise this product. Do not install it in a location which is not stable.

▲ WARNING

Check that there are no wiring cables or other parts beneath the floor mat before cutting the floor mat.

■ Installation of the GPS Antenna

▲ CAUTION

- GPS antenna ④ can be installed either inside or outside of the car, but either way it should be installed as horizontally as possible to allow easy reception of the GPS satellite signals.
- The reception conditions of the GPS satellite will be less favorable with installation inside the car as compared to outside the car. Depending on the type of car, reception of the GPS satellite signals might not be possible with an inside installation. Installation outside of the car is recommended if circumstances allow.
- The GPS antenna should be installed at a position that is spaced at least 12 inch (30 cm) from cellular phone or other transmitting antennas. Signals from the GPS satellite may be interfered with by these types of communication.
- Do not remove the tape from the back of the GPS antenna. When the tape comes off, the waterproof effectiveness is diminished and this may cause a fault in the GPS antenna.
- Painting the GPS antenna with (metallic) paint may cause a drop in performance.

● Installation Outside the Car

Installation to the trunk lid is made with the GPS antenna ④ built-in magnet.

- 1 Affix the waterproof pad that accompanies ⑤ at the place that comes up against the waterproof rubber lining the trunk.
- 2 Draw the cable of ④ from the trunk lid into the trunk.

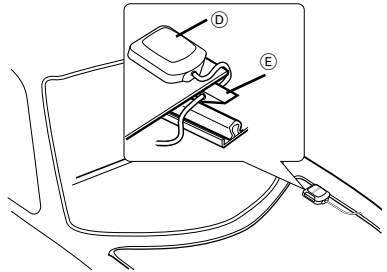

● Installation Inside the Car

Install at a place close to the window surface at the center of the rear tray or on the inside of the rear window to allow easy reception of the GPS satellite signals.

- 1 Peel off the release paper of ⑥ and affix to placement position of ④.
- 2 Place ④ on ⑥.

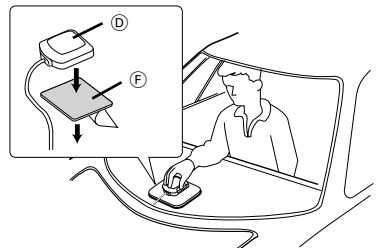

Connection

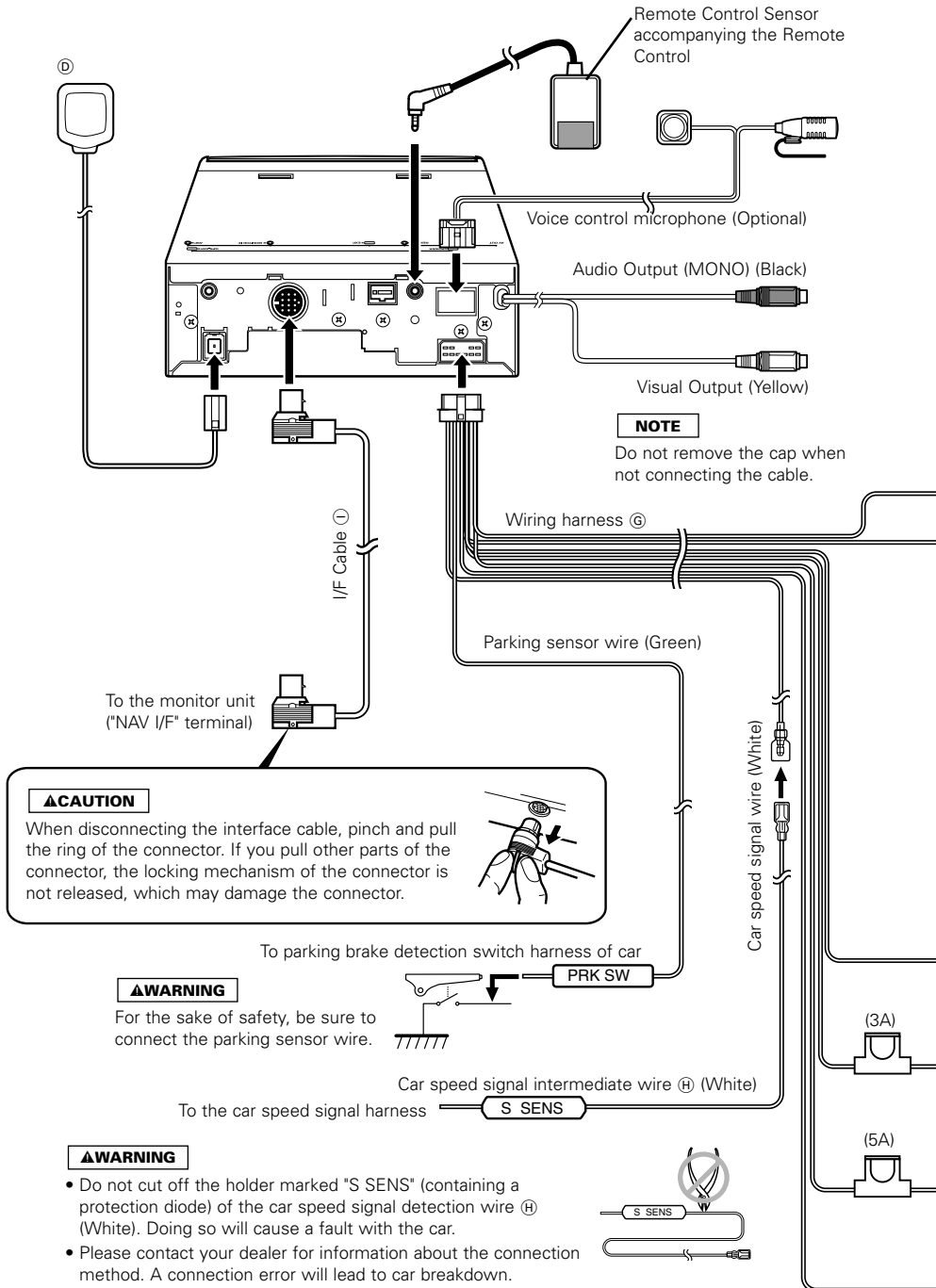

Attaching Remote Control Sensor

When using a TV monitor other than ones manufactured by KENWOOD, attach the Remote Control Sensor following the procedure below:

- 1 Remove the backing paper from the double-sided tape and attach the tape to the back of the Remote Control Sensor.
- 2 After wiping off the dirt or oil from the attachment location, attach the Remote Control Sensor.

NOTE

- Wipe off the dirt or oil from the surface to which the Sensor is attached.
- Avoid locations under direct sunlight or near the TV monitor where signals from the remote controller are not received easily.

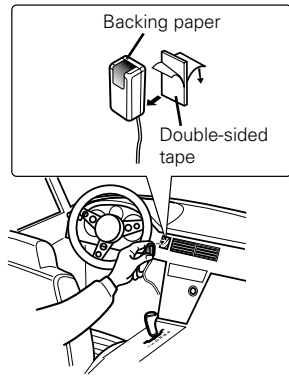

Reverse detection wire (Pink)

To reverse lamp harness of car

TEL mute wire (Brown)

TEL MUTE

Connect to the TEL mute terminal for the navigation system of the KENWOOD car audio.

REVERSE

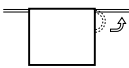
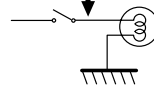

NOTE

If no connections are made, do not let the wire come out from the tab.

Automatic illumination control wire (Orange)

ILLUMI

To car light control switch

Ignition wire (Red) 12 V

ACC

Ignition key switch

Car fuse box

Car fuse box (Main fuse)

Battery wire (Yellow) 12 V

Ground wire (Black) ⊖ (To car chassis)

Battery

